

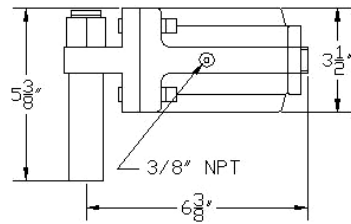

CLEVELAND VIBRATOR Models UH & UHVM

AIR-POWERED PORTABLE VIBRATOR
FOR SMALL HOPPERS, BINS, AND CHUTES

2" UH



1 1/4" UH

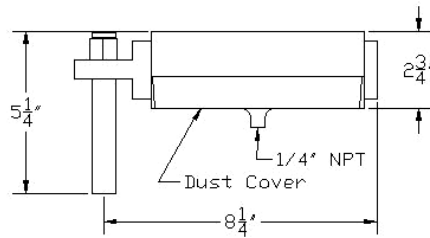

1 1/4" UHVM

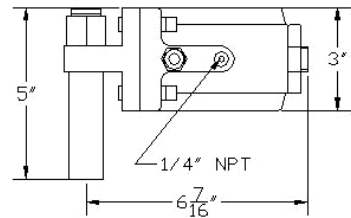

2" UHVM

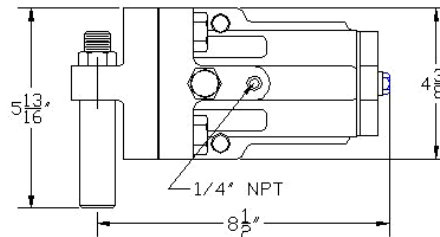

The UH and UHVM air-powered portable vibrators can be utilized on small bins, hoppers or chutes-- wherever a permanent mounted vibrator installation would impede production.

The UH and UHVM vibrators are also ideal for use on concrete forms where complete portability is desired. These rugged vibrators have adjustable high frequency vibration for maximum efficiency.

When the job becomes too big for the 1-1/4" models, the 2" models take over, and can be used with the same mounting bracket.

The vibrators are equipped with an alloy steel stud mounting head which is quickly and easily inserted into the sleeve-type female bracket. Several brackets can be welded in locations where vibration is required allowing the vibrators to be moved from bracket to bracket.

THE CLEVELAND VIBRATOR COMPANY
2828 CLINTON AVE. CLEVELAND, OH 44113
800-221-3298

CLEVELAND VIBRATOR Models UH & UHVM

AIR-POWERED PORTABLE VIBRATOR
FOR SMALL HOPPERS, BINS, AND CHUTES

| UH <i>Coated vibrators for non-lubricated applications are available.</i> | | | | |
|--|----------------------|--------------|--|---|
| MODEL | PISTON DIA. in/cm | WT lbs/kg | AIR CNSMP. scfm/lpm (lpm=liters per min.) @60 psig 4.1 bar | FREQUENCY* (vibrations per min.) @60 psig 4.1 bar |
| UH 1-1/4 | 1-1/4 | 8 3.6 | 6.3 188 | 8000 |
| UH 2 | 2 | 14 6.4 | 9.6 272 | 4500 |
| UHVM 1-1/4 | 1-1/4 3.2 | 8 3.6 | 7.2 204 | 4640 |
| UHVM 2 | 2 5.1 | 23 10.2 | 7.2 204 | 4500 |

Specify UHVM-AC when quiet-operation air-cushioned vibration is required.

**Frequency data obtained through testing under a no-load condition. Frequency will decline as load is increased.*

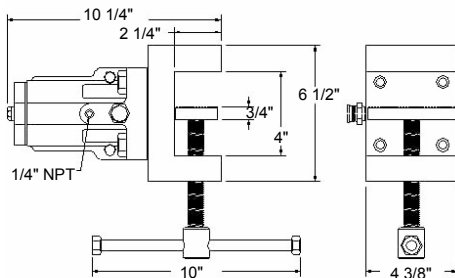

Lightweight and portable, the VGVM air-powered vibrator is easy to handle and popular with operators. On concrete forms, the VGVM attaches quickly to any structural member. The serrated jaws bite firmly on metal or wood. Form time and wasted man hours are reduced. In foundry operations, the VGVM increases core production, gives faster and cleaner draws, and prolongs core box life without core distortion. Frequency and amplitude are controlled by adjusting the air supply. Maintenance is held to a minimum because the piston is the only moving part.

| VGVM <i>Coated vibrators for non-lubricated applications are available.</i> | | | | |
|--|----------------------|--------------|---|---|
| MODEL | PISTON DIA. in/cm | WT lbs/kg | AIR CNSMP. scfm/lpm @60 psig 4.1 bar | FREQUENCY* (vib per min.) @60 psig 4.1 bar |
| 2 | 2 5.1 | 33 14.9 | 7.2 204 | 4500 |

Specify VGVM-AC when quiet-operation air-cushioned vibration is required.

**Frequency data obtained through testing under a no-load condition.*

Frequency will decline as load is increased.

THE CLEVELAND VIBRATOR COMPANY
2828 CLINTON AVE. CLEVELAND, OH 44113
800-221-3298